



TOWN OF LUMSDEN

Development Application Form

LUMSDEN, IN THE QU'APPALLE

1. Owner/Applicant:

Name: _____
 Address: _____
 City/Prov: _____ Postal Code: _____
 Telephone: _____ (Home)
 _____ (Work)

2. Contractor:

Name: _____
 Address: _____
 City/Prov: _____ Postal Code: _____
 Telephone: _____ (Home)
 _____ (Work)

3. Designer:

Name: _____
 Address: _____
 City/Prov: _____ Postal Code: _____
 Telephone: _____ (Home)
 _____ (Work)

4. Surveyor:

Name: _____
 Address: _____
 City/Prov: _____ Postal Code: _____
 Telephone: _____ (Home)
 _____ (Work)

5. Legal description of land for development:

Lot: _____ Block: _____ Plan #: _____
 Civic Address: _____

6. Area of the site proposed for development:

Lot Size: _____ ft.2 OR _____ m2
 Buildings: 1. Description _____ Size _____ (ft.2/m2)
 2. Description _____ Size _____ (ft.2/m2)
 3. Description _____ Size _____ (ft.2/m2)

7. (a) Type of Proposed Development Work:

(b) Intended Use of Development:

8. Description of Proposed Development (describe or explain briefly):

Land clearing proposed: _____
 Excavation/Fill proposed: _____
 Leveling/Grading: _____
 Landscaping: _____
 Drainage: _____

9. Source of Water Supply:

Municipal/Other _____

10. Sewage Disposal:

Municipal/Other _____
 Distance From Water Source _____ Distance From Dwelling _____ (Specify ft. or m)

11. Estimated cost of building (excluding site):

Construction Cost \$ _____

12. Other Comments or Information to Attach:

I SOLEMNLY DECLARE THAT ALL THE ABOVE STATEMENTS CONTAINED WITHIN THIS APPLICATION ARE TRUE, AND I MAKE THIS DECLARATION CONSCIENTIOUSLY BELIEVING IT TO BE TRUE AND KNOWING THAT IT IS OF THE SAME FORCE AND EFFECT AS IF MADE UNDER OATH AND BY VIRTUE OF "THE CANADA EVIDENCE ACT".

Signature of Owner/Applicant: _____ Date of Application: _____

I HAVE NO OBJECTION TO THE ENTRY UPON THE LAND DESCRIBED HEREIN BY THE PERSON(S) BY THE TOWN OF LUMSDEN FOR THE PURPOSE OF SITE INSPECTIONS REQUIRED FOR REVIEWING THIS APPLICATION.

Signature of Owner/Applicant: _____

OFFICE USE:	APPLICATION NO.:	DATE REVIEWED:
DATE RECEIVED:		

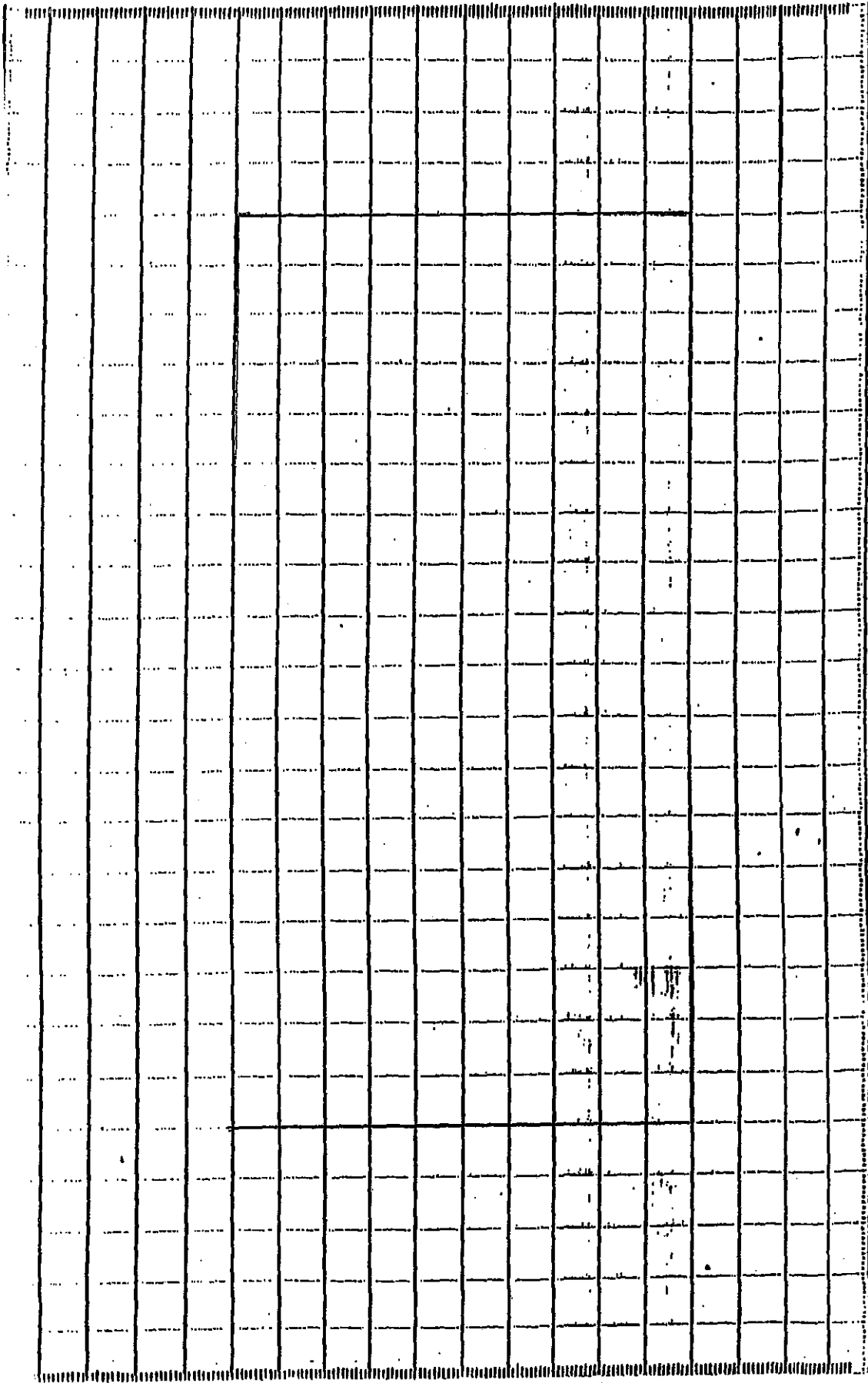

Site Plan

Min front yd. 7.6m
Rear 9m.
Side yd. 1.5m.

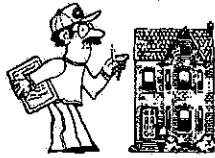

**Professional
Building
Inspections, Inc.**

64 Great Plains Road, Emerald Park, SK S4L 1C3
Ph: 306-536-1799 Fax: 306-781-2112

Permit Information Form

(Must accompany each permit application submission
and be completed by the Administrator.)

PBI Permit No. _____

Permit Request:

Municipality: _____

Development Permit approved: Yes No / Geo-Tech required: Yes No

All *required* items on Plan Review Checklist included: Yes No* (*Do not send to PBI until complete*)

Date of permit application: _____ **Expiry Date:** _____

Project start date: _____

Contact Information:

Telephone No:

Applicant's Name: _____ Bus/Cell: _____
(Not required if same as Registered Owner)

Registered Owner: _____ Home: _____
Bus/Cell: _____

E-mail: _____

Contractor's Name: _____ Bus/Cell: _____
Fax: _____

Property Address:

Civic Address: _____

Legal description: Lot(s) _____, Block _____, Plan No. _____

OR Portion of _____ ¼ section _____, Township _____, Range _____
Subdivision of _____

Project Type:

Dwelling: New Home RTM or Mobile Home Addition Accessory Bldg. Renovation Deck

→ Bsmt Development Garage/attached Garage/detached & insulated Garage/detached & not insulated

Commercial Industrial Other _____

Size of building: _____ ft², Length _____, Width _____, Height _____

Estimated value of construction (excluding site): \$ _____

Finished areas: Main _____ ft² / 2nd Storey _____ ft² / Basement _____ ft² **OR**

Fee for building permit: \$ _____ Basement not developed

Estimated project completion date: _____

Additional Comments: _____

Date Submitted to PBI: _____ Name: _____

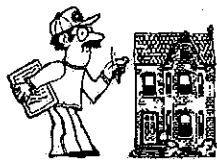

**Professional
Building
Inspections, Inc.**

64 Great Plains Road, Emerald Park, SK S4L 1C3
 Ph: 306-536-1799 Fax: 306-781-2112
 E-mail: office@pro-inspections.ca

Plan Review Checklist

Home Owners/Builders: The following information is required when submitting an application for a residential building permit and before a building permit is issued. The plan review will not begin until all required information is provided.

New Home, Addition, Attached Garage or RTM (Check off items below that are being provided to PBI)

REQUIRED for Plan Review	New Home	Addition	Attached Garage	RTM
2 sets of site plans				
2 sets of Structural/Architectural plans				Supplier Inspection Report
2 sets of Engineered foundation design (site specific)				
Loading on concrete telepost pads or piles			N/R	
Wood and/or steel beam sizes				
Geo-Tech report (if applicable)				
Provide As They Become Available				
2 sets of Engineered roof truss design (site specific)				
2 sets of roof truss layout(s) (site specific)				
2 sets of Engineered floor truss design (site specific)			N/R	
2 sets of floor truss layout(s) (site specific)			N/R	
Residential Mechanical Ventilation Design Summary			N/R	
Manufacturer's installation specs for fireplace/woodstove			N/R	

NOTE: 2 COPIES OF ALL DOCUMENTS AND SPECIFICATION SHEETS ARE REQUIRED

Detached Garage Specifications sheet
 Structural Engineer foundation design (unless slab)
 Site plan

Deck Specifications sheet
 Sketch of deck
 Site plan

Basement Development Specifications sheet
 Sketch of basement development
 Fireplace manufacturer's installation specs ← (if applicable) →

Renovation Specifications sheet
 Sketch of floor plan
 Fireplace manufacturer's installation specs

Home Owner/Builder

Name: _____

Phone # _____

Email: _____

Fax # _____

Construction Site

Address: _____

Lot _____ Block _____

Municipality: _____

Date: ____ / ____ / ____
 (Day / Month / Year)

Detached Garage Specifications for:

Name: _____

Address: _____

Legal Land Location: _____

Phone: _____ Fax: _____

Contractor: _____ Phone: _____

Specifications

Foundation (grade beam & piles) or **Slab** (Page 3)

Foundation: Yes ___ No ___

If "yes" supply site specific drawings stamped by a Structural Engineer

If "no" provide the following:

Slab dimensions: _____ wide x _____ long

Slab thickness overall _____ perimeter _____ (See page 3 for detail)

Type of base _____

Walls

Size & spacing of studs: _____

Size, type & spacing of anchor bolts: _____

Wall/building height to eave: _____ Type of siding: _____

Thickness & type of wall sheeting: _____

Insulation & barrier: Yes ___ No ___

Inside finish: _____ None _____

***Size of each vehicle door: Door #1** - Opening width _____ & Header size _____ ply of 2" x _____

Door #2 - Opening width _____ & Header size _____ ply of 2" x _____ **Door #3** - Opening width _____ & Header size _____ ply of 2" x _____

***Size of windows/man doors & header: 1.** - Opening width _____ & Header size _____ ply of 2" x _____

2. - Opening width _____ & Header size _____ ply of 2" x _____ **3.** - Opening width _____ & Header size _____ ply of 2" x _____

**Note door/window openings on attached sketch, page 2.*

Permit # _____

Town/Village/RM of _____

Date: _____

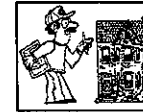

Professional Building Inspections, Inc.

Roof

Engineered trusses by: _____

Spacing of trusses: _____ & overhang: _____

Type of shingles: _____

Ceiling finish: _____

Insulation: _____

Other

Heating: _____

Electrical: _____

Pit or Hoist: _____

Recommend eavetroughs and downspouts

Site Plan (on the reverse side show the following) :

1. Lot dimensions & lot shape
2. Garage location and set backs from lot lines
3. All existing buildings, their dimensions & distance to garage.
4. Location of easements, retaining walls & driveways

Roof Layout

Indicate the location & *size of all doors and windows* and the direction of the roof peak in the drawing below:

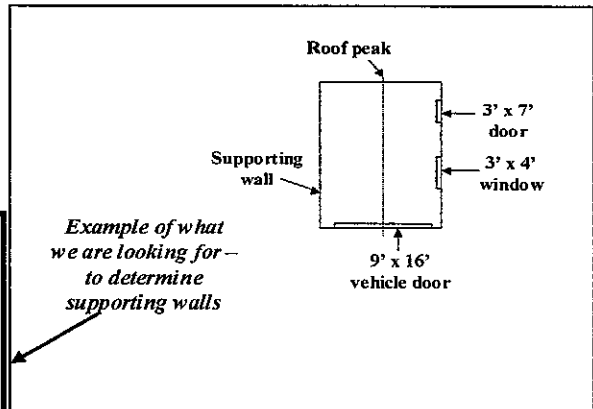
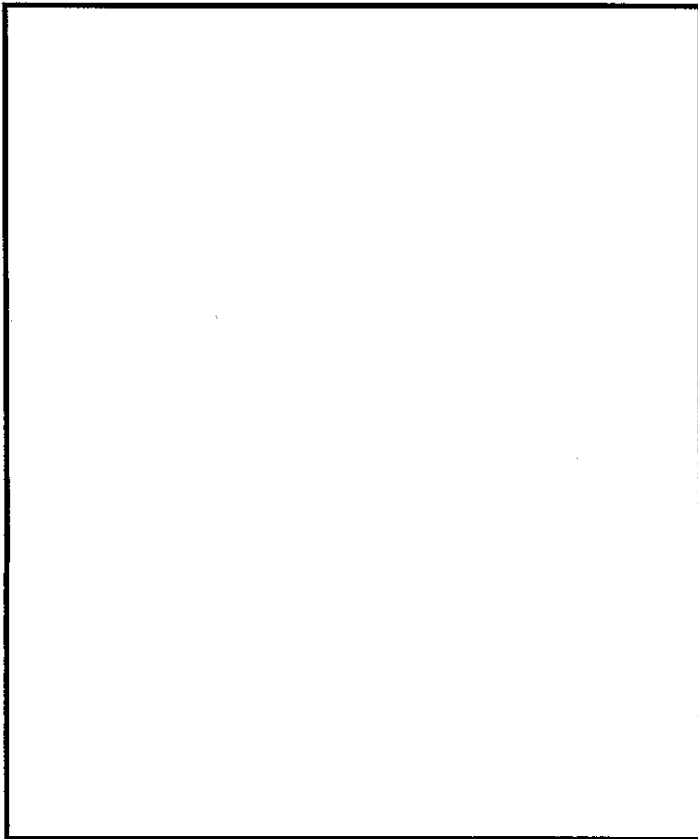

Professional Building Inspections, Inc.

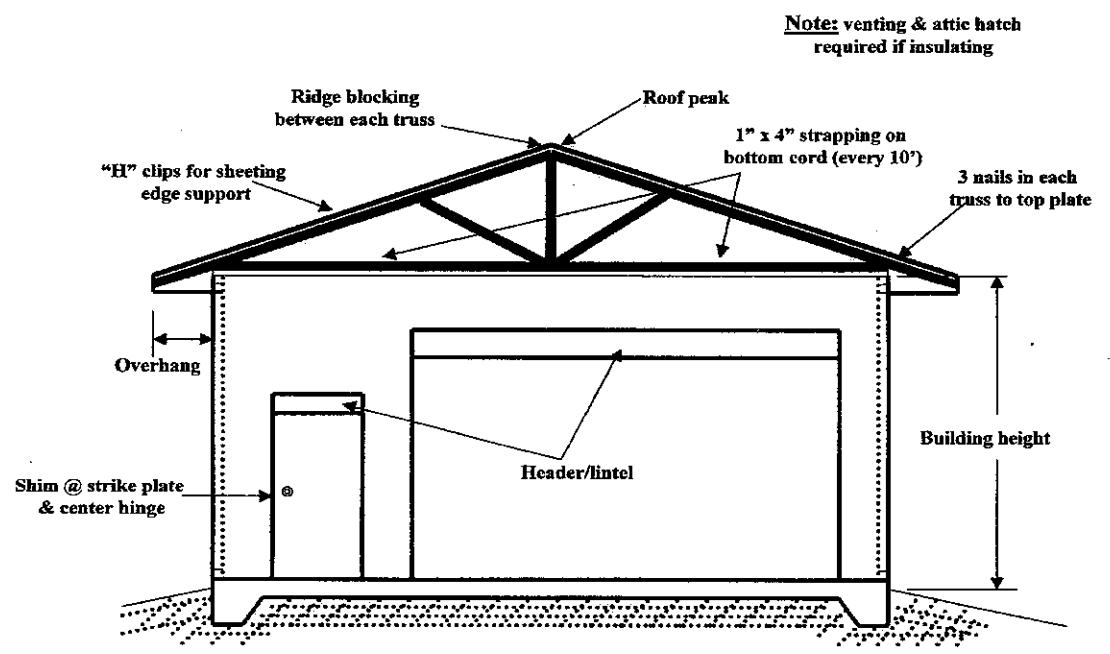

Recommended Reinforced Thickened Edge Concrete Slab



Professional
Building
Inspections, Inc.

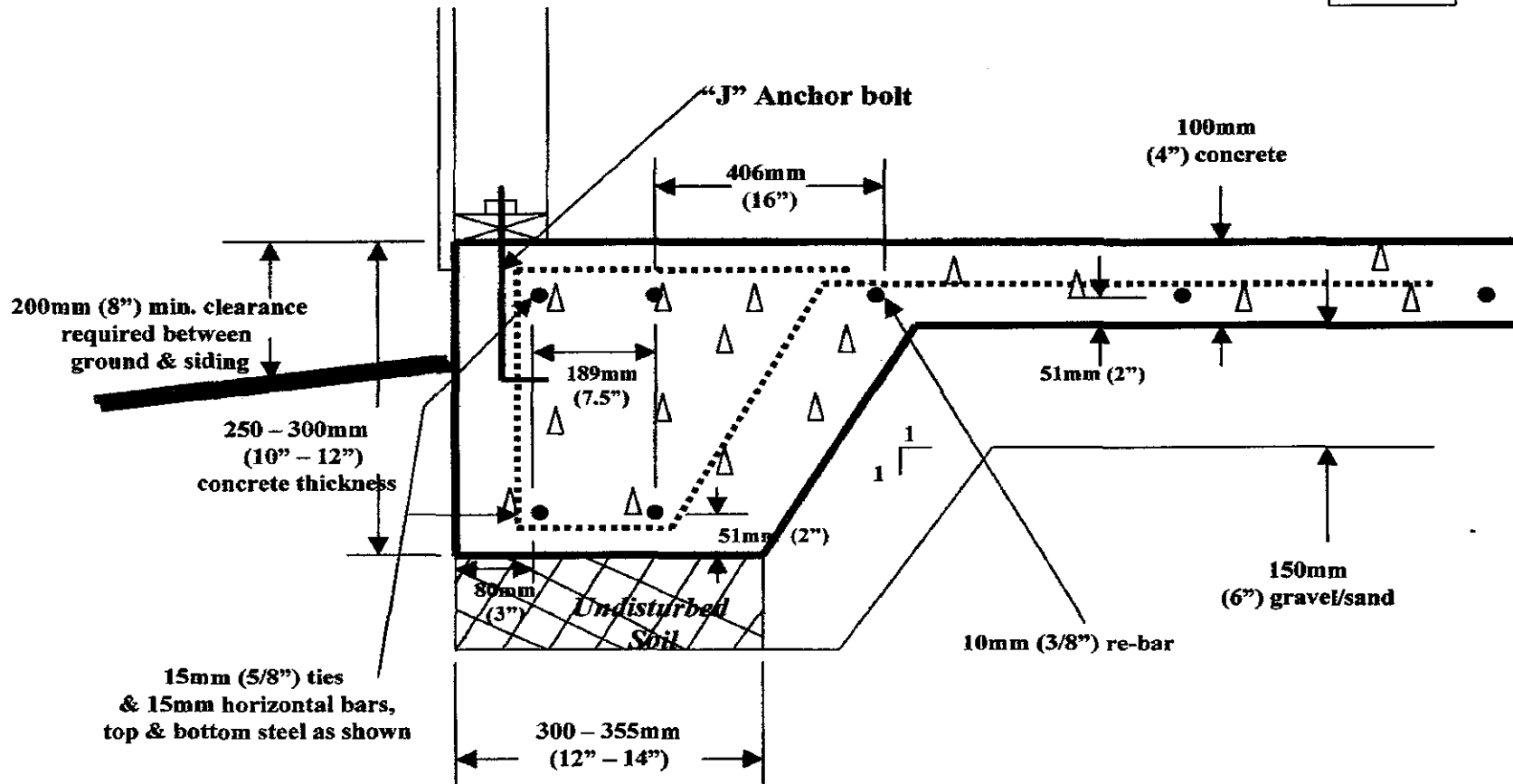

Notes:

1. 102mm (4") thick reinforced concrete slab with 10mm (3/8") dia re-bar at 406mm (16") on center each placed on:
 - 1a. 6 mil poly cover and (as per CGS B51.34M)
 - 1b. 152mm (6") deep compacted gravel base.
2. Around the perimeter place 12.7,, (1/2") x 203mm (8") anchor bolts or equivalent at 900mm (36" to 48") spacing